

Phasemation

CC-1200R

BALANCED PHONO CABLE

Owner's Manual

Main Features

- 1. A Balanced Transmission of the Cartridge Output**
The power generation of the MC cartridge is by the coil. Since opposite phase (push-pull) signals are generated at both ends of the coil, it makes a balanced operation. Therefore, balanced transmission to the phono amplifier is the utmost way to minimize loss. The weak voltage of the cartridge is what makes it exert its strength.
- 2. A Balanced Transmit From the RCA Output Terminal**
Although the RCA terminal is unbalanced, the record player's RCA terminal is not grounded and therefore the CC-1200R has a special structure that allows it to send a balanced transmission.
- 3. PC TripleC Material**
In order to bring out 100% of the cartridge's performance, an ultra-thick PC Triple C wire of 1.25 Sq (mm²) was adopted. PC Triple C's low distortion rate and high conductivity allow the weak signal from the cartridge to be transmitted to the phono amplifier without loss of signals.
- 4. Rhodium Plating**
The RCA plug are rhodium-plated which has a reputation for high sound quality.

Names, Functions, and Connections

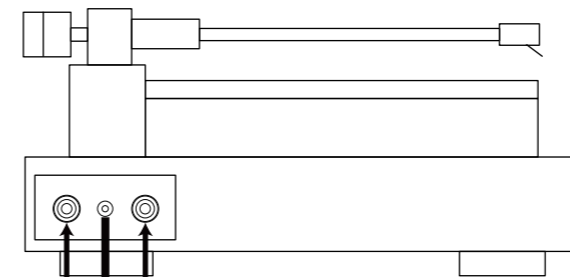

- ① RCA Connector and Earth Terminal**
Connect to the tone arm and to the RCA outputs of the player. The RCA output of the player are floating with earth, and therefore it is specially structured so that they can be connected in balance.

Caution

Some players, such as those with built-in phono amplifiers (RCA outputs not floating with earth) will generate hum noises.

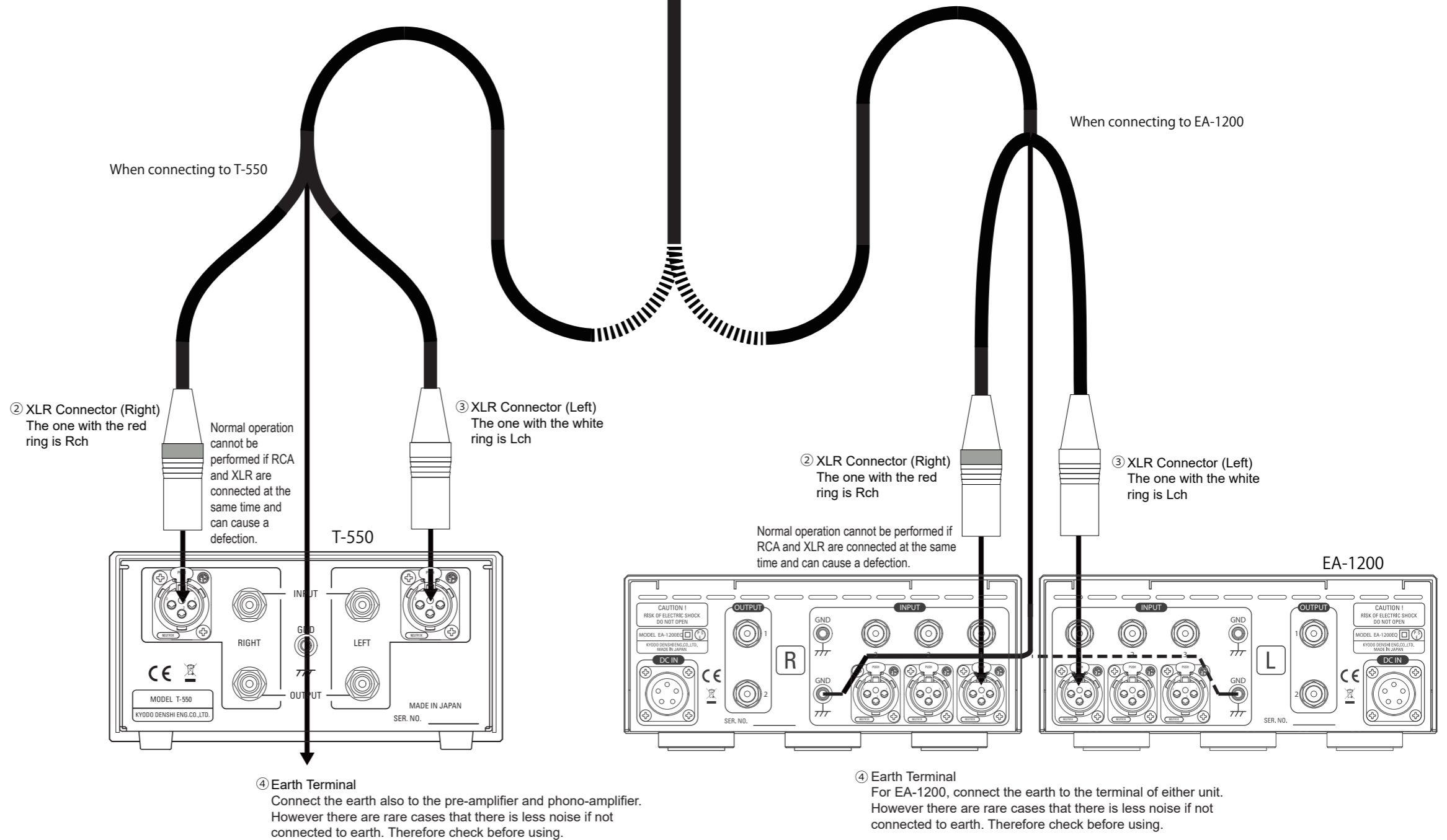

Phasemation

Kyodo Denshi Engineering Co., Ltd.
8-40-17 Shinyoshidahigashi, Kohoku-ku,
Yokohama-shi, Kanagawa 223-0058 Japan
TEL: +81-45-710-0975
FAX: +81-45-710-0976
E-mail: info@phasemation.com
URL: https://www.phasemation.com